

Date: 05/28/2024 **Author:** Traffic King Ent **Project:** Knight Rd, Chilliwack

Comments:

- While work takes place the EB lane on Knight Rd traffic will be single lane alternating in the west bound lane.
- Advanced Warning Sign distances may be shortened due to urban block length.
- 3.5m lane width to be maintained.
- TCP to assist construction vehicles ingress / egress.
- TCP to identify & illustrate escape route once on site.
- TCPs will assist pedestrians and cyclists as needed
- TCPs are compliant with the MOTI TMM 2020 and WSBC OHS Regulation Part 18 regarding flaggers positioning.
- TCP's to be positioned on sidewalk/curb/off traveled roadway.
- All signs and traffic control devices are to comply with MOTI Manual for Work on Roadways
- Signs to be removed during non-working hours and traffic pattern restored to original layout

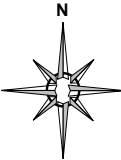
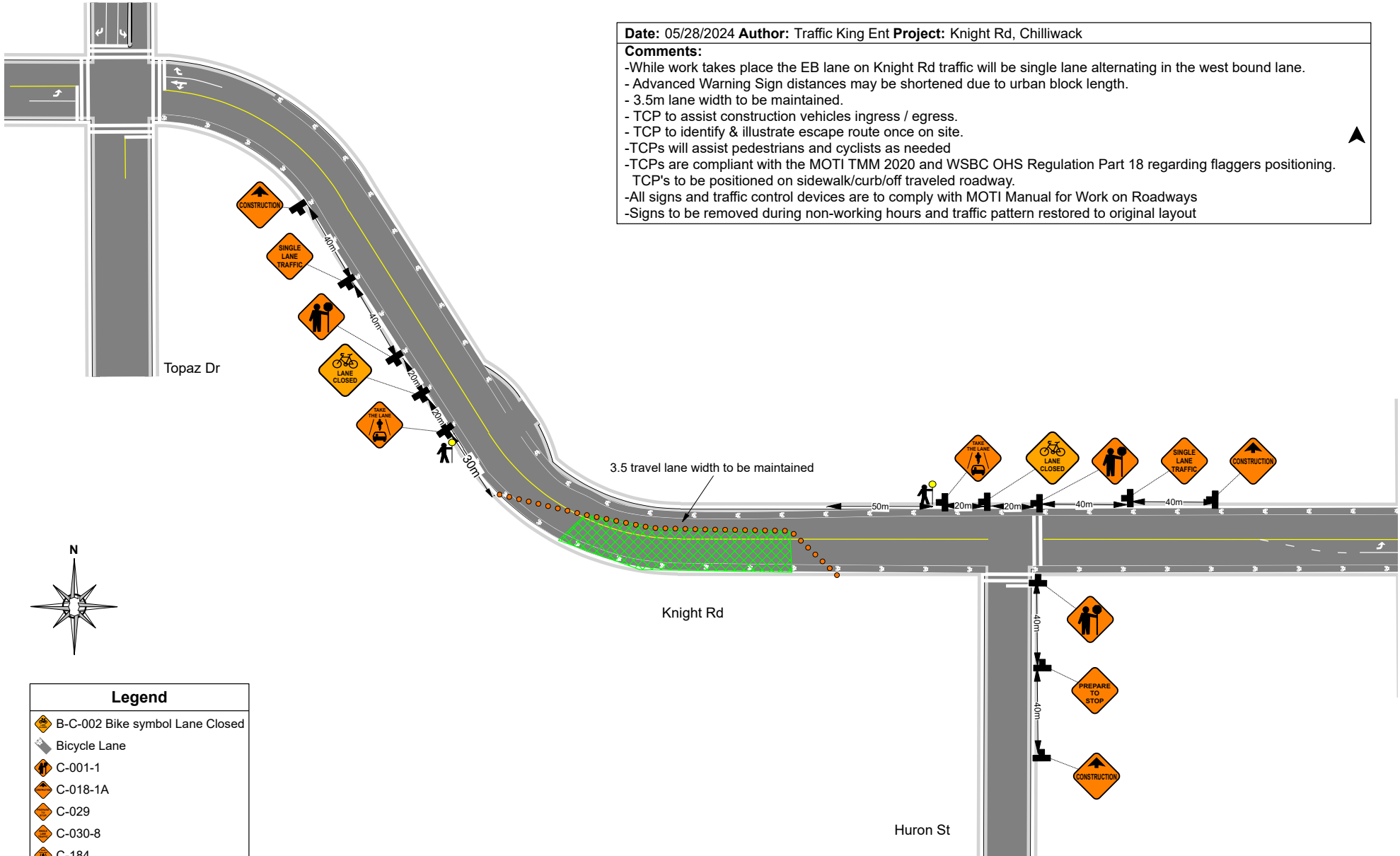

| Legend | |
|--------|---------------------------------|
| | B-C-002 Bike symbol Lane Closed |
| | Bicycle Lane |
| | C-001-1 |
| | C-018-1A |
| | C-029 |
| | C-030-8 |
| | C-184 |
| | Delineator |
| | Sign Stand |
| | traffic controller |
| | Work Area |